



T4VH 335-20Z-1914

- 1 Cable entry M 20 x 1.5
- Metal enclosure
- Wide range of alternative actuators
- Good resistance to oil and petroleum spirit
- 40,5 mm x 76 mm x 38 mm
- Actuator heads can be repositioned by 4 x 90°
- Design to EN 50041

Data

Ordering data

Product type description	T4VH 335-20Z-1914
Article number (order number)	101150920

General data

Housing construction form	Norm construction design
Actuator type to EN 50041	A
Housing material	Light alloy die-casting
Housing coating material	painted
Lever material	Metal film
Gross weight	270 g

General data - Features

Number of auxiliary contacts	1
Number of safety contacts	1

Safety classification

Standards	BG-GS-ET-15 EN ISO 13849-1 EN IEC 60947-5-1
Mission time	20 Year(s)

Mechanical data

Actuating element	Roller lever
Roller material	Plastic
Mechanical lifetime, minimum	30,000,000 Operations
Actuating speed, maximum	2.5 m/s
Note (Actuating speed)	Actuating speed with actuating angle 30° to switch axis
Note (Switchover time)	Switchover time in accordance with actuating speed
Actuating torque, minimum	0.3 Nm

Mechanical data - Connection technique

Termination	Screw terminals M20 x 1.5
Cable section, minimum	0.75 mm ²
Cable section, maximum	2.5 mm ²
Note	All indications including the conductor ferrules.

Mechanical data - Dimensions

Length of sensor	60.6 mm
Width of sensor	40.5 mm
Height of sensor	129.5 mm

Ambient conditions

Degree of protection	IP65 IP67
Ambient temperature	-30 ... +80 °C

Ambient conditions - Insulation values

Rated insulation voltage U_i	500 V
Rated impulse withstand voltage U_{imp}	6 kV

Electrical data

Thermal test current	10 A
Required rated short-circuit current	1,000 A
Utilisation category AC-15	230 VAC
Utilisation category AC-15	4 A
Utilisation category DC-13	24 VDC
Utilisation category DC-13	4 A
Switching element	2 NO contact
Switching principle	Slow action
Bounce duration, maximum	2 ms
Maximale Schalthäufigkeit	5,000 /h
Material of the contacts, electrical	Silver

Note

Note (General) Switch with 2 NO contacts are not for security tasks

Ordering code

Product type description:

(1)(2) 3(3)-(4)Z(5)-(6)-(7)-(8)-(9)

(1)

Z	Snap action
T	Slow action

(2)

S	Plunger S
----------	-----------

R	Roller plunger R
H	Roller lever H
10H	Rod lever 10H
7H	Roller lever 7H
1K	Offset roller lever 1K
3K	Angle roller lever 3K
RMS	Brass roller
4V.	Basic device for roller lever (without actuator)

(3)

335	slim design
355	large design

(4)

11	1 NO contact/1 NC contact
02	2 NC contact
20	2 NO contacts (not suitable for safety applications)
01/01	1 NC contact left / 1 NC contact right
12	1 NO contact/2 NC contacts
03	3 NC contact

(5)

H	Slow action with staggered contacts
UE	Slow action with overlapping contacts
2272	2272 Special roller bolt with collar
1183	with aluminium rod
1699-1	Exterior stainless steel bolts and clamp

(6)

G24	with LED
------------	----------

(7)

1	Cable entry M20
M20	Cable entry M20

NPT	Cable entry NPT 1/2"
ST	M12 connector with A-coding (Caution! According to EN 60204-1, the versions with connector must only be used in PELV circuits.)
ST-2310	M12 connector with B-coding (Caution! According to EN 60204-1, the versions with connector must only be used in PELV circuits.)

(8)

2138	Roller lever 7H for position switches with safety function
-------------	--

(9)

1637	Gold-plated contacts
-------------	----------------------

Pictures

Product picture (catalogue individual photo)



ID: k335hf01
 | 1.0 MB | .jpg | 352.778 x 834.319 mm - 1000 x 2365 px - 72 dpi
 | 133.6 kB | .png | 74.083 x 174.978 mm - 210 x 496 px - 72 dpi
 | 28.2 kB | .png | 74.083 x 74.083 mm - 210 x 210 px - 72 dpi
 | 12.6 MB | .png | 169.333 x 400.473 mm - 2000 x 4730 px - 300 dpi

Dimensional drawing basic component

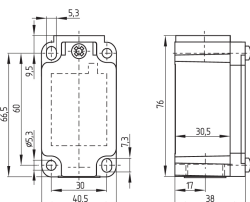

ID: 1-335g01
 | 96.7 kB | .cdr |
 | 4.5 kB | .png | 74.083 x 51.506 mm - 210 x 146 px - 72 dpi
 | 105.8 kB | .jpg | 352.778 x 245.886 mm - 1000 x 697 px - 72 dpi

Dimensional drawing actuator

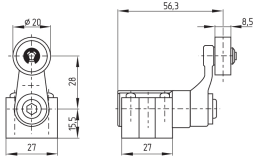

ID: 1h336g01

| 65.6 kB | .cdr |

| 4.1 kB | .png | 74.083 x 51.858 mm - 210 x 147 px - 72 dpi

| 84.5 kB | .jpg | 352.778 x 247.297 mm - 1000 x 701 px - 72 dpi

Switch travel diagram

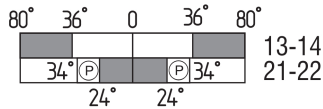

ID: kh335s05

| 25.4 kB | .cdr |

| 2.4 kB | .png | 74.083 x 24.342 mm - 210 x 69 px - 72 dpi

| 66.9 kB | .jpg | 352.778 x 116.064 mm - 1000 x 329 px - 72 dpi

Switch travel diagram

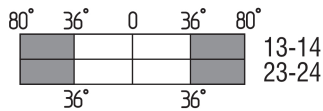

ID: kh335s04

| 24.0 kB | .cdr |

| 1.7 kB | .png | 74.083 x 23.636 mm - 210 x 67 px - 72 dpi

| 53.5 kB | .jpg | 352.778 x 112.889 mm - 1000 x 320 px - 72 dpi

Diagram

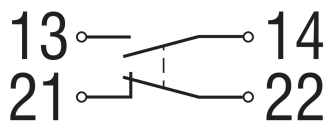

ID: k1o1sk01

| 52.2 kB | .jpg | 352.778 x 143.581 mm - 1000 x 407 px - 72 dpi

| 2.6 kB | .png | 74.083 x 29.986 mm - 210 x 85 px - 72 dpi

Diagram

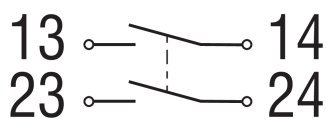

ID: k--2sk01

| 51.9 kB | .jpg | 352.778 x 135.819 mm - 1000 x 385 px - 72 dpi

| 2.6 kB | .png | 74.083 x 28.575 mm - 210 x 81 px - 72 dpi

K.A. Schmersal GmbH & Co. KG, Möddinghofe 30, 42279 Wuppertal

The details and data referred to have been carefully checked. Images may diverge from original. Further technical data can be found in the manual. Technical amendments and errors possible.

Generated on: 27/02/2026, 14:13