



AZM 170SK-11/02ZRKA 24VAC/DC

- 1 Cable entry M 20 x 1.5
- Screw connection
- Thermoplastic enclosure
- Double-insulated
- Compact design
- Interlock with protection against incorrect locking.
- Long life
- High holding force

Data

Ordering data

Product type description	AZM 170SK-11/02ZRKA 24VAC/DC
Article number (order number)	101183253
EAN (European Article Number)	4030661319070
eCl@ss number, version 12.0	27-27-26-03
eCl@ss number, version 11.0	27-27-26-03
eCl@ss number, version 9.0	27-27-26-03
ETIM number, version 7.0	EC002593
ETIM number, version 6.0	EC002593

Approvals - Standards

Certificates	cULus CCC
--------------	--------------

General data

Standards	EN ISO 13849-1 EN ISO 14119 EN IEC 60947-5-1
Coding level according to EN ISO 14119	Low
Working principle	electromechanical
Housing material	Plastic, glass-fibre reinforced thermoplastic, self-extinguishing
Gross weight	345 g

General data - Features

Power to lock	Yes
Increased latching force	Yes
Number of actuating directions	2
Number of auxiliary contacts	1
Number of safety contacts	3

Safety classification

Standards	EN ISO 13849-1
Performance Level, up to	c
Category	1
B _{10D} Normally-closed contact (NC)	2,000,000 Operations
Note	Electrical life on request.
B _{10D} Normally-open contact (NO)	1,000,000 Operations
Note	at 10% I _e and ohmic load
Mission time	20 Year(s)

Safety classification - Fault exclusion

Please note:	Can be used when fault exclusion for dangerous damage to the 1-channel mechanism is permissible and sufficient protection against manipulation is guaranteed.
Performance Level, up to	d
Category	3

Note for 2-channel use and with suitable logic unit.

Mission time 20 Year(s)

Mechanical data

Mechanical lifetime, minimum 1,000,000 Operations

Holding force F_{Zh} in accordance with EN ISO 14119 1,000 N

Holding force F_{max} , maximum 1,300 N

Latching force 30 N

Positive break travel 11 mm

Positive break force per NC contact, minimum 8.5 N

Positive break force, minimum 17 N

Actuating speed, maximum 2 m/s

Mounting Screws

Type of the fixing screws 2x M4

Tightening torque of the fastening screws for the housing cover, minimum 0.7 Nm

Tightening torque of the fastening screws for the housing cover, maximum 1 Nm

Note Torx T10

Mechanical data - Connection technique

Cable entry 1 x M20 x 1,5

Cable cross-section of the cable glands, minimum 4 mm

Cable cross-section of the cable glands, maximum 10 mm

Cable section, minimum 0.25 mm²

Cable section, maximum 1.5 mm²

Note All indications including the conductor ferrules.

Wire cross-section, minimum 24 AWG

Wire cross-section, maximum	16 AWG
Allowed type of cable	solid single-wire solid multi-wire flexible
Terminal (mechanical)	Screw terminals

Mechanical data - Dimensions

Length of sensor	30 mm
Width of sensor	90 mm
Height of sensor	100.5 mm

Ambient conditions

Degree of protection	IP67
Ambient temperature	-25 ... +60 °C
Storage and transport temperature	-25 ... +85 °C
Note (Relative humidity)	non-condensing non-icing
Protection class	II
Permissible installation altitude above sea level, maximum	2,000 m

Ambient conditions - Insulation values

Rated insulation voltage U_i	250 VAC
Rated impulse withstand voltage U_{imp}	4 kV
Overvoltage category	III
Degree of pollution	3

Electrical data

Operating current	4,000 mA
Required rated short-circuit current	1,000 A
Electrical power consumption, maximum	12 W

Switching element	Magnet: 1 NO contact, 1 NC contact / Actuator: 2 NC contacts
Note (Switching element)	Change-over contact with double break, type Zb or 2 NC contacts, with galvanically separated contact bridges
Switching principle	slow action, positive break NC contact
Maximale Schalthäufigkeit	1,000 /h
Material of the contacts, electrical	Silver

Electrical data - Magnet control

Magnet switch-on time	100 %
Test pulse duration, maximum	5 ms
Test pulse interval, minimum	50 ms

Electrical data - Safety contacts

Voltage, Utilisation category DC-13	24 VDC
Current, Utilisation category DC-13	4 A

Electrical data - Auxiliary contacts

Voltage, Utilisation category DC-13	24 VDC
Current, Utilisation category DC-13	4 A

Other data

Note (applications)	sliding safety guard removable guard hinged safety guard
---------------------	--

Scope of delivery

Scope of delivery	Actuator must be ordered separately. Slot sealing plugs
-------------------	--

Note

Note (Manual release)

bottom

For manual release using M5 triangular key, available as accessory

Ordering code

Product type description:

AZM 170(1)-(2)Z(3)K(4)-(5)-(6)-(7)-(8)

(1)	
SK	Cut clamps Screw connection
(2)	
11	1 NO contact/1 NC contact
02	2 NC contact
(3)	
R	Latching force 5 N Latching force 30 N
(4)	
A	Power to unlock Power to lock
(5)	
ST	Cable entry M20 2 connector, M12, 4-pin
ST-2431	As per the ST with additional individual solenoid monitoring
ST8	Connector M12 8-pole
(6)	
24 VAC/DC	Us 24 VAC/DC
110 VAC	Us 110 VAC
230 VAC	Us 230 VAC

(7)

1637

Gold-plated contacts

(8)

Manual release

2197

Manual release from side (default in the power-to-unlock version)

2405

Emergency exit from side

Pictures

Product picture (catalogue individual photo)



ID: kazm1f59

| 612.9 kB | .jpg | 352.778 x 395.111 mm - 1000 x 1120 px - 72 dpi

| 72.8 kB | .png | 74.083 x 82.903 mm - 210 x 235 px - 72 dpi

| 64.6 kB | .jpg | 110.419 x 123.472 mm - 313 x 350 px - 72 dpi

| 56.4 kB | .png | 74.083 x 74.083 mm - 210 x 210 px - 72 dpi

| 6.3 MB | .png | 211.561 x 237.067 mm - 1999 x 2240 px - 240 dpi

Dimensional drawing basic component

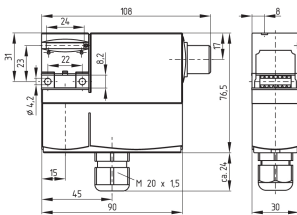

ID: laz1g07

| 44.4 kB | .cdr |

| 10.1 kB | .png | 74.083 x 51.506 mm - 210 x 146 px - 72 dpi

| 126.8 kB | .jpg | 352.778 x 245.181 mm - 1000 x 695 px - 72 dpi

Diagram

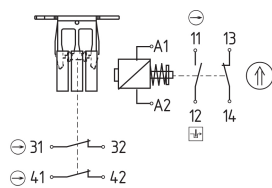

ID: kazm1k76

| 80.1 kB | .ai | 210.002 x 297 mm - 595 x 841 px - 72 dpi

| 100.8 kB | .jpg | 352.778 x 266.7 mm - 1000 x 756 px - 72 dpi

| 4.6 kB | .png | 74.083 x 56.092 mm - 210 x 159 px - 72 dpi

11	12	13	14	31	32	41	42	A1	A2
----	----	----	----	----	----	----	----	----	----

K.A. Schmersal GmbH & Co. KG, Möddinghofe 30, 42279 Wuppertal

The details and data referred to have been carefully checked. Images may diverge from original. Further technical data can be found in the manual. Technical amendments and errors possible.

Generated on: 27/02/2026, 15:01